

proposal

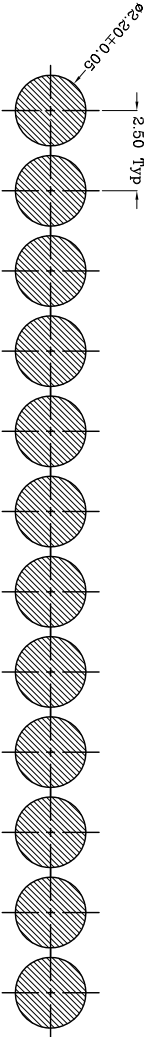

Recommended PCB Layout

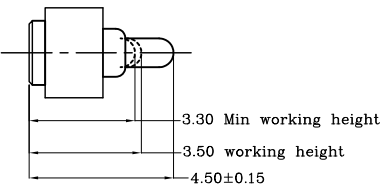
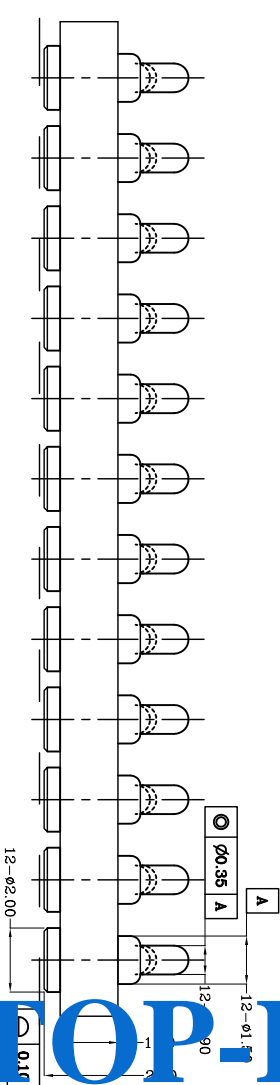
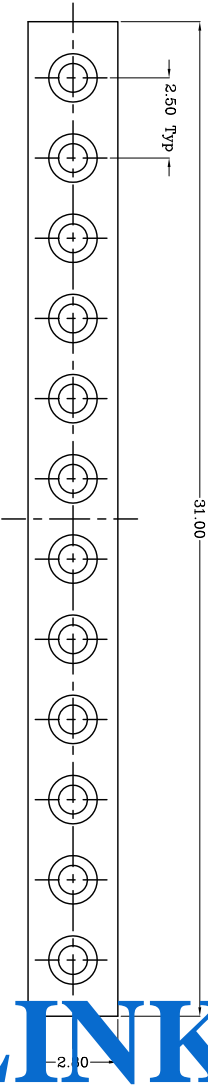

TOP-LINK

Item	Part name	Q'ty/Ea'	Material	Finish
1	HSG	1	High temp.Plastic UL94 V-0 Color Black	_____
2	Body	12	Leaded Brass	Gold plating over Nickel plating
3	Plunger	12	Leaded Brass	Gold plating over Nickel plating
4	Spring	12	Stainless steel wire	_____
5				

Table 1 Mechanical performance		
working height	3.50mm	130±30gf
Durability	100000cycle	

Notes:

- 1 Dimensions shall be interpreted per ASME Y14.5M.
- 2 Mechanical performance(See the table 1)  
<2.1>The force is the average of forces obtained when plunger goes downwards and upwards.  
<2.2>Warning:Working height are not permitted to be less than Min working height.
- 3 Electrical performance  
Resistance:30mOhm Max.  
Current rating: 2.0A  
4 Recommended reflow temperature  
<4.1>Max temp:260°C  
<4.2>Peak time(245°C):10sec min  
<4.3>220°C Time:80sec max  
<4.4>190°C±10°C time:120 sec.±30sec
- 5 RoHS compliant.

1101021-12
PART NUMBER

Type	Unit	Weight
Top-Link Electronics Ltd. TOLERANCES UNLESS OTHER SPECIFIED 0.0 = ±0.15 0.00 = ±0.10 0.000 = ±0.05 Angle: ±1° SURF. TEXTURE: REMOVE BURRS. BREAK SHARP EDGES R0.05 MAX.DO NOT SCALE PRINT.	mm	
DWN: JERRY	APVD:	Top-Link Electronics Ltd.
CHK:	REL:	
Name	Pogo pin connector	
Scale	Size	DWG No.
1:1	A4	C-1101021
Page	1/1	Rev. 2

DIST  
---

2	Change the force:130±30gf	2013/08/05
1	NEW	2013/08/02
Rev.	Revision record.	Date.