

TOP-LINK

| Item | Part name | Q'ty/Ea' | Material | Finish |
|------|-----------|----------|---|----------------------------------|
| 1 | HSG | 1 | High temp.Plastic UL94 V-0 Color Black | _____ |
| 2 | Body | 4 | Leaded Brass | Gold plating over Nickel plating |
| 3 | Plunger | 4 | Leaded Brass | Gold plating over Nickel plating |
| 4 | Spring | 4 | Stainless steel wire | _____ |
| 5 | CAP | 1 | High temp.Plastic UL94 V-0 Color Black | _____ |

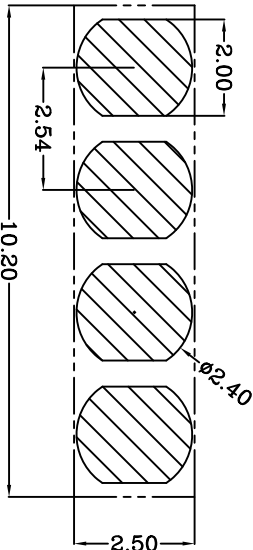

Recommended PCB Layout

| Table 1 Mechanical performance | | |
|--------------------------------|------------|---------------|
| Max.working height | 6.00mm | 85gf min<2.1> |
| Min.working height | 5.30mm | 200gf max |
| Durability | 10000cycle | |

Notes:

- 1 Dimensions shall be interpreted per ASME Y14.5M.
- 2 Mechanical performance(See the table 1)
<2.1>The force is the average of forces obtained when plunger goes downwards and upwards.
<2.2>Warning:Working height are not permitted to be less than Min working height.
- 3 Electrical performance
Resistance:50mOhm Max.Current rating: 2.0A
- 4 Packaging Spec:Conformance to EIA 481
- 5 RoHS compliant.

| Top-Link Electronics Ltd. | | Type | Unit | Weight | PART NUMBER | |
|-----------------------------------|-------|------------------|-------|----------|-------------|------|
| TOLERANCES UNLESS OTHER SPECIFIED | | Customer drawing | mm | | 100224-4 | |
| 0.0 | ±0.15 | DWN: | APVD: | | | |
| 0.00 | ±0.10 | CHK: | REL: | | | |
| 0.000 | ±0.05 | | | | | |
| SURF. TEXTURE: | | Name | | | | |
| REMOVE BURRS: | | Customer drawing | | | | |
| BREAK SHARP EDGES | | Scale | Size | DWG No. | Page | Rev. |
| R0.05 MAX.D0 NOT | | 1:1 | A4 | C-100224 | 1/1 | 1 |
| SCALE PRINT. | | | | | | |

TOP-LINK
Electronics

Top-Link
Electronics Ltd.

DIST

| | | |
|------------------|------------|-------|
| Rev. | NEW | Date. |
| Revision record. | 2011/11/24 | |